



PESTANA

PALÁCIO do FREIXO

POUSADA & NATIONAL MONUMENT

COLLECTION HOTELS

DOURO • PORTO • PORTUGAL





PESTANA

PALÁCIO do FREIXO

POUSADA & NATIONAL MONUMENT
COLLECTION HOTELS
DOURO • PORTO • PORTUGAL

Pestana Palácio do Freixo, classified as a **National Monument since 1910**, is located on the **banks of the Douro River**, named after the famous Wine Region in Portugal, which dates back to Roman times.

Characterized by its sumptuous **18th century construction**, the work was originally authorized by the celebrated Italian architect **Nicolau Nasoni**, one of the most significant architects of the Oporto city with an important contribution to its Historic Heritage. The palace was ordered built by the Dean of the Cathedral of Oporto, D. Jerónimo de Távora e Noronha – a wealthy lord within Douro and Minho and responsible for bringing the famous Italian architect to Oporto.

The Palácio do Freixo consists of **2 separate buildings** which are connected: that of the Palace where you can find the **restaurant, the bar, and the lounges**, and the **old Harmony mill factory** which has 87 comfortable rooms some of which come with a **magnificent view of the Douro River**. There are **several meeting rooms** in both buildings.

The **direct access to the river and the long path by the river** allows the guests easy exploration of the area around the riverside.

The Pestana Palácio do Freixo, Pousada National Monument is a member of **"The Leading Hotels of the World"**, which places it among the most luxurious and exquisite hotels of the world.





PESTANA

PALÁCIO do FREIXO

POUSADA & NATIONAL MONUMENT

COLLECTION HOTELS

DOURO • PORTO • PORTUGAL



87
ROOMS



1 RESTAURANT
2 BARS



MEETING
ROOMS



SPA &
HEALTH CLUB



SAUNA &
TURKISH BATH



FITNESS
CENTER



INDOOR POOL
& JACUZZI



OUTDOOR
POOL



10.000M2
GARDENS



ROOM
SERVICE



LAUNDRY
SERVICE



PARKING



PESTANA
PALÁCIO do FREIXO
POUSADA & NATIONAL MONUMENT
COLLECTION HOTELS
DOURO • PORTO • PORTUGAL



EST. 1948
THE LEADING HOTELS
OF THE WORLD®



PESTANA
PALÁCIO do FREIXO
POUSADA & NATIONAL MONUMENT
COLLECTION HOTELS
DOURO • PORTO • PORTUGAL

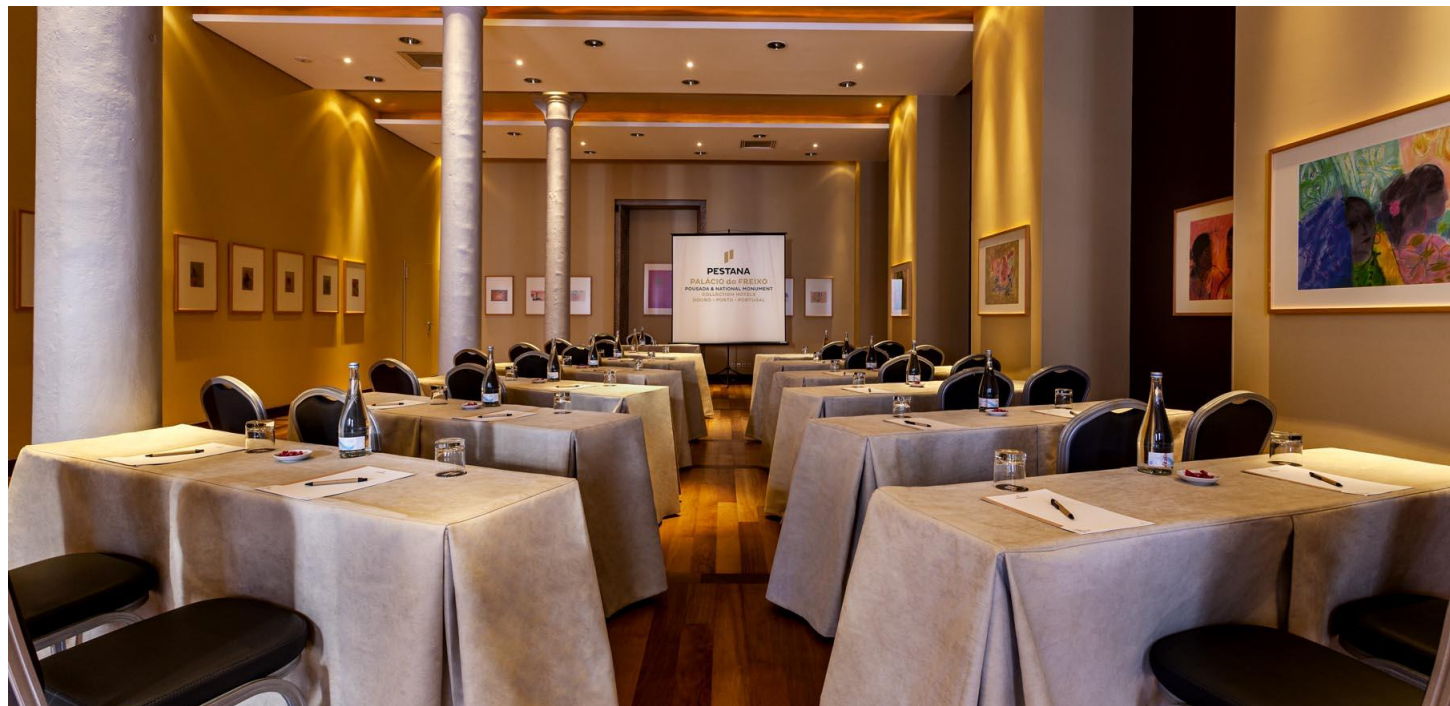
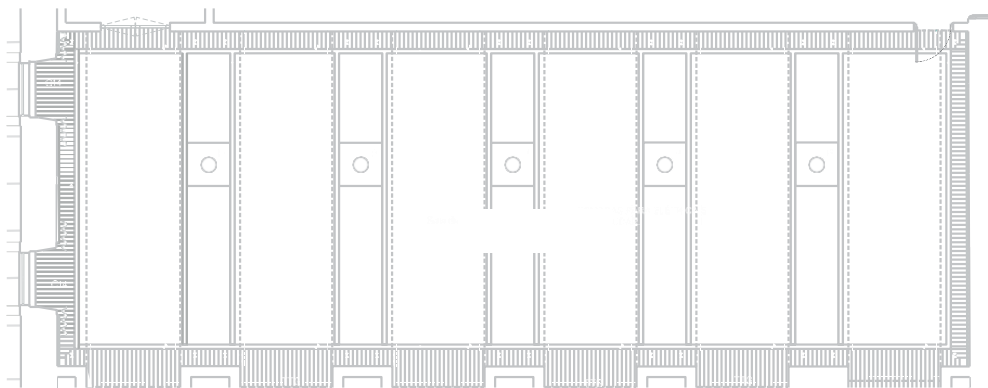

EST. 1948
THE LEADING HOTELS
OF THE WORLD®

D. JERÓNIMO ROOM
162 m²

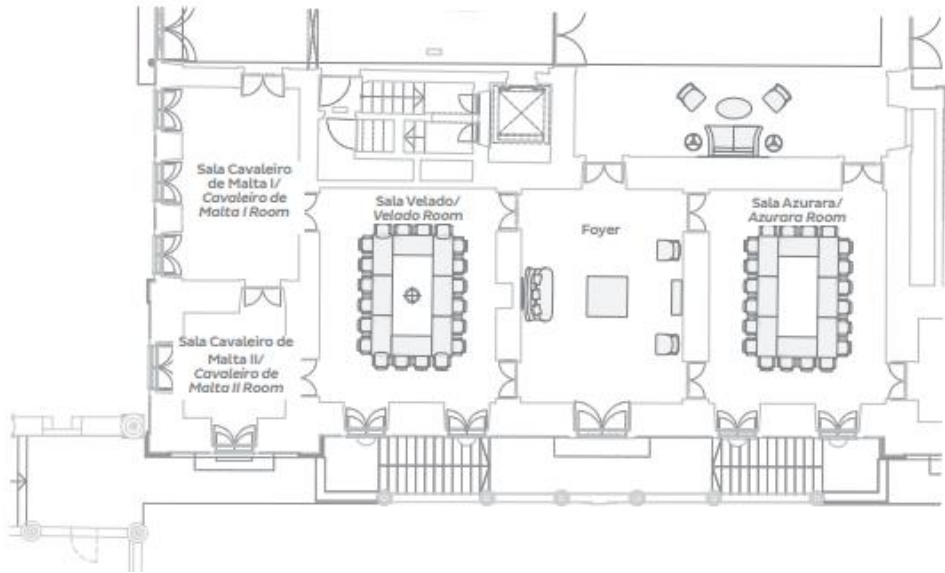

PESTANA
PALÁCIO do FREIXO
POUSADA & NATIONAL MONUMENT
COLLECTION HOTELS
DOURO • PORTO • PORTUGAL

THE LEADING HOTELS
OF THE WORLD





MEETING PACKAGE I

(minimum 30 people)

Main meeting room: pads, pens, sweets

Coffee station: still and sparkling mineral water

Coffee Break "Café de Paris": coffee, tea, milk, orange juice, mineral water, dry fruits mini pastry, mini pain au chocolate, mini croissants with cheese, mini croissants with ham

Chef's lunch Buffet or Chef's Menu

(Starter, main course, dessert, coffee & mignardises)

Beverage package with mineral water and soft drinks;

Supplement for wines: €6,00 per person

€69,00 per person – Full day

€57,00 per person – Half day



MEETING PACKAGE II

(minimum 30 people)

Main meeting room: pads, pens, sweets

Coffee station: still and sparkling mineral water

Coffee Break: coffee, tea, milk, orange juice, mineral water, biscuit selection

Chef's light lunch Buffet

Beverage package with mineral water and soft drinks

Supplement for wines: €6,00 per person

€58,00 per person – Full day

€48,00 per person – Half day



PESTANA

PALÁCIO do FREIXO

POUSADA & NATIONAL MONUMENT

COLLECTION HOTELS

DOURO • PORTO • PORTUGAL